

# Calipers

## ABSOLUTE Inside Caliper SERIES 573 — Knife-edge/Inside Groove/Point Jaw Type

- Specially designed for inside measurements. Select the right model for your workpiece shape.

### Knife-edge type

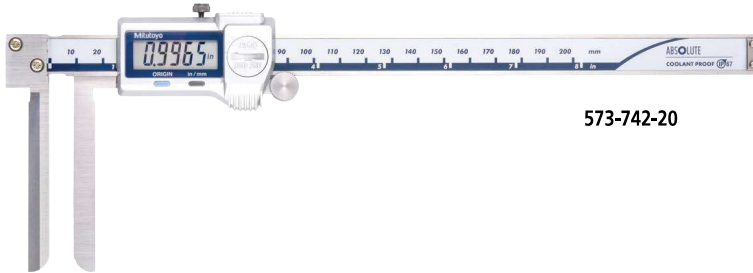

573-742-20

### Inside groove type



573-745-20

Compensation value

### Point jaw type



573-746-20

Compensation value

## SPECIFICATIONS

Inch / Metric	Digimatic model			Remarks
Order No.	Range	Resolution	Accuracy*	
573-742-20	0.4 - 8 in/ 10 - 200 mm	0.0005 in/ 0.01 mm	/	Knife-edge type, Measurable min.
573-745-20* <sup>2</sup>	0.404 - 6.4 in/ 10.26 - 160.16 mm			Inside groove type, Measurable min.
573-746-20* <sup>2</sup>	0.804 - 6.8 in/ 20.42 - 170.32 mm			Point jaw type, Measurable min.

Metric	Digimatic model			Remarks
Order No.	Range (mm)	Resolution (mm)	Accuracy (mm)*	
573-642-20	10 - 200	0.01	/	Knife-edge type, Measurable min.
573-643-20* <sup>1</sup>	10 - 200			Knife-edge type, Measurable min.
573-645-20* <sup>2</sup>	10.1 - 160			Inside groove type, Measurable min.
573-647-20* <sup>1</sup>	10.1 - 160			Inside groove type, Measurable min.
573-646-20* <sup>2</sup>	20.1 - 170			Point jaw type, Measurable min.
573-648-20* <sup>1</sup>	20.1 - 170			Point jaw type, Measurable min.

• Power source: SR44 battery (1 pc.), **938882** included as standard (for operational checks)

• Battery life: Approx. 5 years under normal use

\*  $E_{MPE}$  (ISO 13385-1:2019 and ASME B89.1.14-2018). Largest value across the measuring range. See page D-47 for MPE table.

\*<sup>1</sup> Without thumb roller

\*<sup>2</sup> Includes the offsetting function, which indicates the actual measurement value.

MeasurLink ENABLED  
Data Management Software by Mitutoyo

U-WAVE fit

ABSOLUTE™



Dust- and  
Wear-  
Protected



### Measurement example



### Optional Accessories

Order No.	Type	Description
264-020	—	USB Input Tool Series USB Keyboard Signal Conversion Type <b>IT-020U</b>
05CZA624	A	Connection cable for <b>IT/DP/MUX</b> (1 m)
05CZA625	A	Connection cable for <b>IT/DP/MUX</b> (2 m)
06AFM380A	A	USB Input Tool Direct (2 m)
02AZD730G	IP67	<b>U-WAVE-T</b>
02AZD880G	Buzzer	<b>U-WAVE-T</b>
02AZE200	—	<b>U-WAVE-T</b> mounting bracket
02AZD790A	A	Connection cable for <b>U-WAVE-T</b> (160 mm)
02AZE140A	A	Connection cable for <b>U-WAVE-T</b> For foot switch
264-620	IP67	<b>U-WAVE-TC</b>
264-621	Buzzer	<b>U-WAVE-TC</b>
264-624	IP67	<b>U-WAVE-TCB</b>
264-625	Buzzer	<b>U-WAVE-TCB</b>
02AZF310	IP67	Connecting unit for <b>U-WAVE-TC/TCB</b>

Note: **U-WAVE-TC/TCB** cannot be used with Knife-edge Type (573-642-20, 573-643-20 and 573-742-20).

## DIMENSIONS

Unit: mm

Knife-edge type: 573-642-20, 573-643-20, 573-742-20

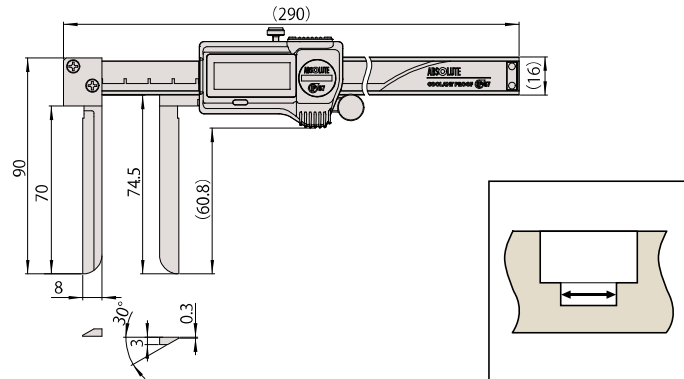

Inside groove type: 573-645-20, 573-647-20, 573-745-20

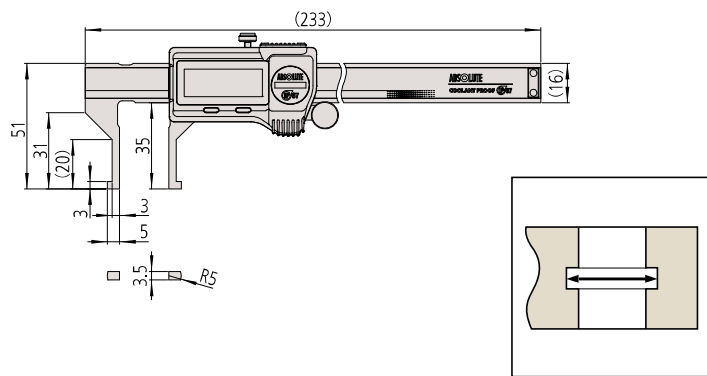

Point jaw type: 573-646-20, 573-648-20, 573-746-20

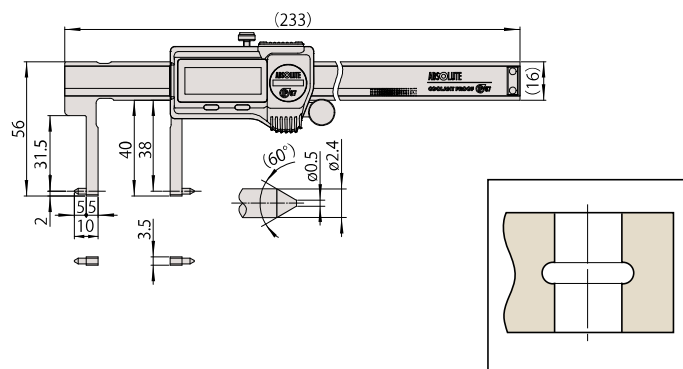

# Calipers

## ABSOLUTE Inside Caliper SERIES 536 — Knife-edge/Inside Groove/Point Jaw Type

- Specially designed for inside measurement. Select the right model for your workpiece shape.

Knife-edge type

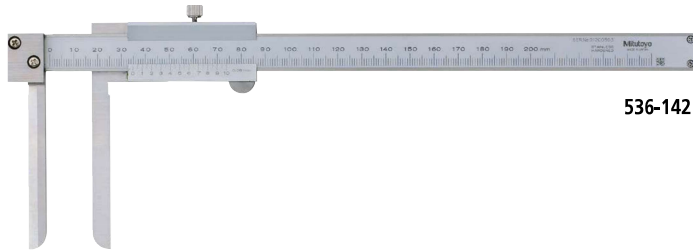

536-142

Inside groove type

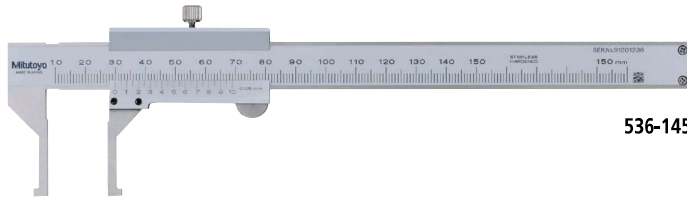

536-145

Point jaw type



536-146

## SPECIFICATIONS

Metric		Analog model		
Order No.	Range (mm)	Graduation (mm)	Accuracy (mm)*	Remarks
536-142	10 - 200	0.05	/	Knife-edge type, Measurable min.
536-145	10.1 - 150			Inside groove type, Measurable min.
536-146	20.1 - 150			Point jaw type, Measurable min.
536-147	30.1 - 300			Point jaw type, Measurable min.
536-148	70.1 - 450			Point jaw type, Measurable min.
536-149	70.1 - 600			Point jaw type, Measurable min.

\*  $E_{MPE}$  (ISO 13385-1:2019 and ASME B89.1.14-2018). Largest value across the measuring range. See page D-47 for MPE table.

## DIMENSIONS

Knife-edge type: 536-142

Unit: mm

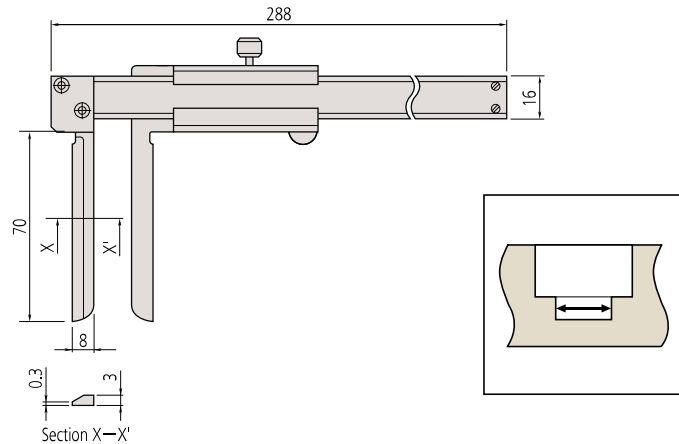

Inside groove type: 536-145

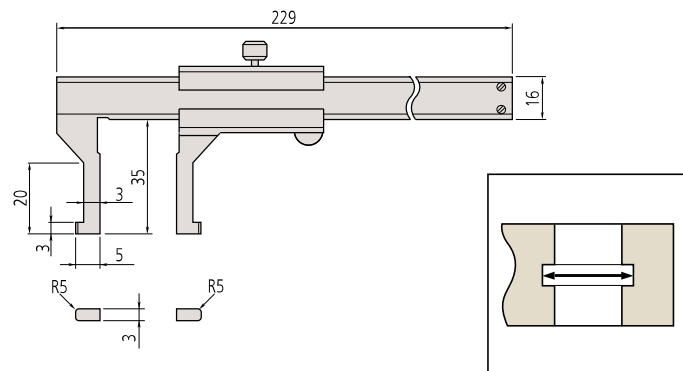

Point jaw type: 536-146, 147, 148, 149

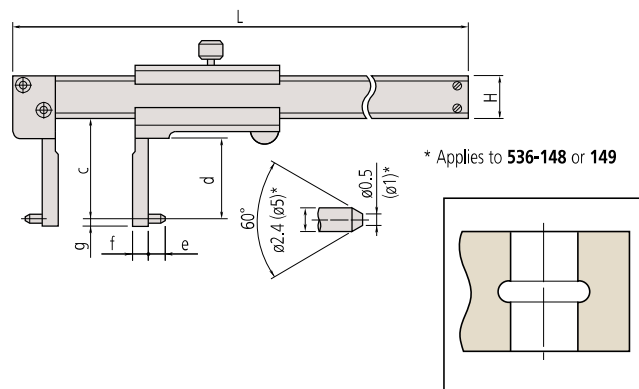

\* Applies to 536-148 or 149

Range (mm)	c	d	e	f	g	H	L
150	38	31	5	5	2	16	229
300	98	89		10			403
450	145	136	10	25	5	25	610
600							750

Note: Models with a measuring range of more than 300 mm have slightly different appearance. For details, contact your nearest M<sup>3</sup> Solution Center



MRM Metrology Inc.  
905 595 1000  
sales@MRMmetrology.com  
www.MRMmetrology.com