

# Micrometers

## Setting Standards for Outside Micrometers SERIES 167

- Used for setting the zero point on outside micrometers.



167-148

### SPECIFICATIONS and DIMENSIONS

167-101 to 167-103  
167-141 to 167-143

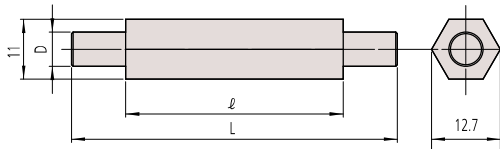

Unit: mm

Inch					
Order No.	Length <L> (in)	Accuracy (in)	Parallelism (in)	Flatness (in)	Diameter <D> (in)
167-141	1	±0.00005	0.00008	0.000012	18
167-142	2	±0.0001			40
167-143	3	±0.0001			40

Metric					
Order No.	Length <L> (mm)	Accuracy (μm)	Parallelism (μm)	Flatness (μm)	Diameter <D> (mm)
167-101	25	±1.5	2.0	0.3	18
167-102	50	±2.0			40
167-103	75	±2.5			40

167-104 to 167-107  
167-144 to 167-147

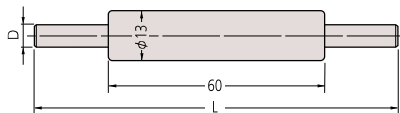

Unit: mm

Inch					
Order No.	Length <L> (in)	Accuracy (in)	Parallelism (in)	Flatness (in)	Diameter <D> (in)
167-144	4	±0.0001	0.00008	0.000012	0.31
167-145	5	±0.00015			
167-146	6				
167-147	7				

Metric					
Order No.	Length <L> (mm)	Accuracy (μm)	Parallelism (μm)	Flatness (μm)	Diameter <D> (mm)
167-104	100	±3	2.0	0.3	7.9
167-105	125	±3.5			
167-106	150	±4			
167-107	175	±4.5			

167-108 to 167-119  
167-148 to 167-159

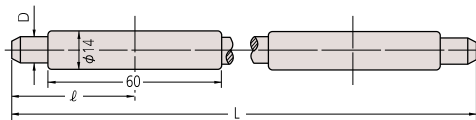

Unit: mm

Inch					
Order No.	Length <L> (in)	Accuracy (in)	Parallelism (in)	Flatness (in)	Diameter <D> (in)
167-148	8	±0.00015	0.00008	0.000012	0.37
167-149	9	±0.0002			
167-150	10	±0.0002			
167-151	11	±0.0002			
167-152	12	±0.00025			
167-153	13	±0.00025			
167-154	14	±0.00025			
167-155	15	±0.00025			
167-156	16	±0.00025			
167-157	17	±0.00025			
167-158	18	±0.00025			
167-159	19	±0.0003			

Metric					
Order No.	Length <L> (mm)	Accuracy (μm)	Parallelism (μm)	Flatness (μm)	Diameter <D> (mm)
167-108	200	±5.0	2.0	0.3	9.4
167-109	225	±5.5			
167-110	250	±6.0			
167-111	275	±6.5			
167-112	300	±7			
167-113	325	±7.5			
167-114	350	±8			
167-115	375	±8.5			
167-116	400	±9			
167-117	425	±9.5			
167-118	450	±10			
167-119	475	±10.5			

### Typical application



### Micrometer Inspection Gage Block Set

Refer to page B-13 for details.



516-152/153/154



Micro Checker (holder only)  
516-607

# Micrometers

## Setting Standards for Outside Micrometers SERIES 167

Unit: mm

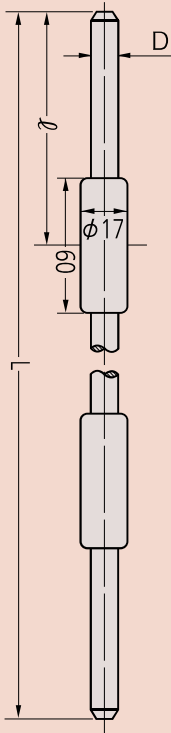

167-120 to 167-404  
167-160 to 167-443

Inch						
Order No.	Length <L> (in)	Accuracy (in)	Parallelism (in)	Flatness (in)	ℓ (mm)	Diameter <D> (in)
167-160	20	±0.0003	0.00008	0.00012	106	0.47
167-161	21				112	
167-162	22				117	
167-163	23				122	
167-164	24				128	
167-165	25				133	
167-166	26				138	
167-167	27				142	
167-168	28				147	
167-169	29				153	
167-170	30	±0.00035	0.00008	0.00012	158	0.47
167-171	31				164	
167-172	32				170	
167-173	33				175	
167-174	34				180	
167-175	35				185	
167-176	36				191	
167-177	37				196	
167-178	38				201	
167-179	39				207	
167-180	40	211				
167-405	41	±0.0004				0.47
167-406	42					
167-407	43					
167-408	44					
167-409	45					
167-410	46					
167-411	47					
167-412	48					
167-413	49					
167-414	50					
167-415	51	±0.0004				0.47
167-416	52					
167-417	53					
167-418	54					
167-419	55					
167-420	56					
167-421	57					
167-422	58					
167-423	59					
167-424	60					
167-425	61					
167-426	62					
167-427	63					
167-428	64					
167-429	65					
167-430	66					
167-431	67					
167-432	68					
167-433	69					
167-434	70					
167-435	71					
167-436	72					
167-437	73					
167-438	74					
167-439	75					
167-440	76					
167-441	77					
167-442	78					
167-443	79					

Metric						
Order No.	Length <L> (mm)	Accuracy (μm)	Parallelism (μm)	Flatness (μm)	ℓ (mm)	Diameter <D> (mm)
167-120	500	±11	2.0	0.3	106	11.9
167-121	525	±11.5			112	
167-122	550	±12			117	
167-123	575	±12.5			122	
167-124	600	±13			128	
167-125	625	±13.5			133	
167-126	650	±14			138	
167-127	675	±14.5			142	
167-128	700	±15			147	
167-129	725	±15.5			153	
167-130	750	±16	158	2.0	11.9	
167-131	775	±16.5	164			
167-132	800	±17	170			
167-133	825	±17.5	175			
167-134	850	±18	180			
167-135	875	±18.5	185			
167-136	900	±19	191			
167-137	925	±19.5	196			
167-138	950	±20	201			
167-139	975	±20.5	207			
167-140	1000	±21	211			
167-365	1025	±21.5	2.0	0.3	217	11.9
167-366	1050	±22			222	
167-367	1075	±22.5			227	
167-368	1100	±23			232	
167-369	1125	±23.5			238	
167-370	1150	±24			243	
167-371	1175	±24.5			248	
167-372	1200	±25			254	
167-373	1225	±25.5			259	
167-374	1250	±26			264	
167-375	1275	±26.5	269			
167-376	1300	±27	275	2.0	11.9	
167-377	1325	±27.5	280			
167-378	1350	±28	285			
167-379	1375	±28.5	291			
167-380	1400	±29	296			
167-381	1425	±29.5	301			
167-382	1450	±30	306			
167-383	1475	±30.5	312			
167-384	1500	±31	317			
167-385	1525	±31.5	322			
167-386	1550	±32	328			
167-387	1575	±32.5	333			
167-388	1600	±33	338			
167-389	1625	±33.5	343			
167-390	1650	±34	349			
167-391	1675	±34.5	354			
167-392	1700	±35	359			
167-393	1725	±35.5	364			
167-394	1750	±36	370			
167-395	1775	±36.5	375			
167-396	1800	±37	380			
167-397	1825	±37.5	386			
167-398	1850	±38	391			
167-399	1875	±38.5	396			
167-400	1900	±39	401			
167-401	1925	±39.5	407			
167-402	1950	±40	412			
167-403	1975	±40.5	417			
167-404	2000	±41	423			



MRM Metrology Inc.

905 595 1000

sales@MRMmetrology.com

www.MRMmetrology.com